

Outer diameter Stroke

M4 × 4mm

Outer diameter Stroke

M6 × 4mm

●Specifications are subject to change without notice

F
Fixed

FK-0604 Series



Dimension

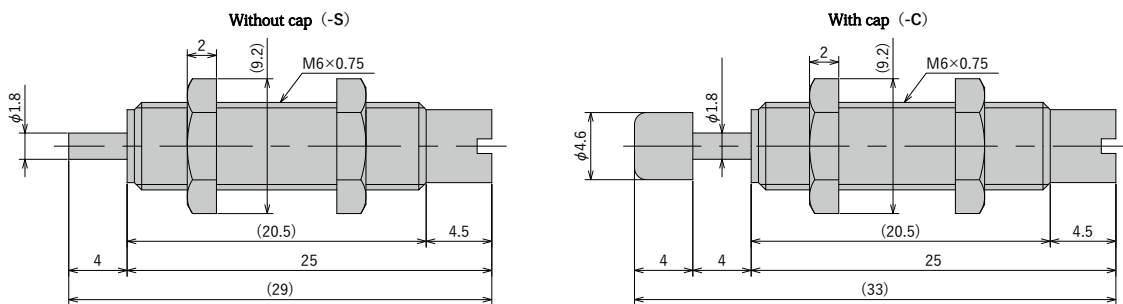

Specifications

Model	Stroke mm	Max. absorption energy J (kgf·m)	Max. equivalent mass kg (kgf)	Range of impact rate m/s	Max. drag N (kgf)	Max. cycle rate cycle/min	Max. absorption energy per minute J/min (kgf·m/min)	Recovering power of piston rod N (kgf)	Operating temperature °C	Mass g	Orifice type	Oil type
FK-0604L-S	4	0.1 (0.01)	1 (1)	0.3~1	363 (37)	45	4.5 (0.46)	3 (0.3) or lower	-5~70	4.1	Groove orifice	Silicon oil
FK-0604L-C										4.2		
FK-0604H-S		0.5 (0.05)	3 (3)				22.5 (2.29)			4.1		
FK-0604H-C							4.2					
FK-0604B-S		0.7 (0.07)	7 (7)		31.5 (3.21)		4.1					
FK-0604B-C							4.2					

Precautions for Use

* Ensure that an external stopper (OP-020**) is also used. (The FK-0404 and FK-0604 series can be used without a stopper.)